

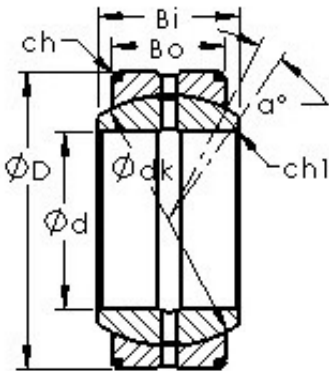

BEARING Driveshaft USA CORP.



AST GEC440XS plain bearings

Bearing No. GEC440XS

Bore Diameter	440 mm
Outer Diameter	600 mm
Bearing Type	large size
Bore Dia (d)	440.0000
Outer Dia (D)	600.0000
Outer Width (Bo)	185.0000
Inner Width (Bi)	218.0000
Dynamic Load Rating (Cr)	8,650,000
Static Load Rating (Cor)	42,300,000
Max. shaft corner radius, or 45 deg. chamfer (ch1)	1.500
Max. housing corner radius, or 45 deg. chamfer (ch)	4.000
Spherical Diameter (dk or Dk)	520.000
Mis-alignment Angle (a deg.)	3
Weight (g)	196,000.00
Material	Inner and Outer ring made from 52100 Chrome steel, or equivalent

GEC440XS Bearing 2D drawings and 3D CAD models